



General characteristics

toothed bush in steel
 sleeve in polyamide
 no lubrication
 resists to all types of lubricants and hydraulic fluid
 temperature range : from -25°C to +80°C



Selection

The transmitted torque must be lower than the nominal torque (see technical characteristics) divided by the service factor.

$$C = \frac{9550 \times P}{N} < \frac{T}{f_s}$$

C : torque in Nm
 P : power in kW
 N : speed in rpm
 T : nominal torque in Nm
 f_s : service factor

The starting torque must be lower than the maximum torque.

With a constant torque and a good alignment of shafts, the coupling can be used over the maximum torque.

Misalignments reduce the allowable speed (see opposite table)

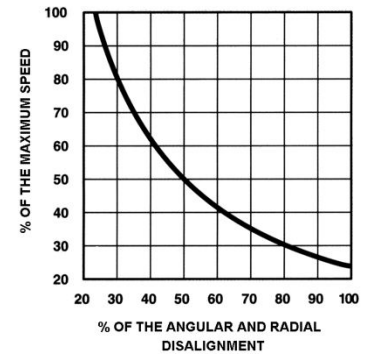

Technical characteristics

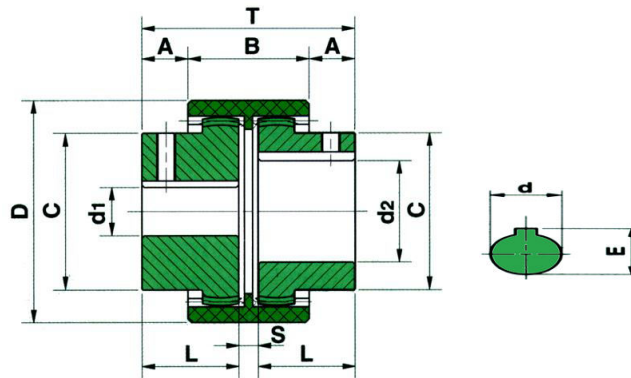

Size	Dimensions										max. speed tr/min	nom. torque Nm	max. torque Nm	Misalignments			inertia J kg cm ²	load kg
	min. d1 mm	max. d2 mm	E mm	A mm	B mm	C mm	D mm	L mm	S mm	T mm				axial ± mm	radial mm	ang. [°]		
40 - 14	5	14	16.3	6.5	37	25	40	20	10	50	14 000	10	20	± 1	± 0.3	± 1° per hub	0.23	0.16
48 - 19	10	19	21.8	7.5	37	32	48	21	10	52	11 800	16	32		± 0.3		0.42	0.24
52 - 24	10	24	27.3	7	40	36	52	21	12	54	10 600	20	40		± 0.4		0.84	0.33
66 - 28	8	28	31.3	18	46	44	66	35	12	82	8 500	45	90		± 0.4		2.8	0.86
76 - 32	12	32	35.3	17	48	50	76	35	12	82	7 500	60	120		± 0.4		4.9	1.1
83 - 38	12	38	41.3	17	48	58	83	35	12	82	6 700	80	160		± 0.4		7.8	1.4
92 - 42	12	42	45.3	19	50	68	92	38	12	88	6 000	100	200		± 0.4		12.9	1.96
98 - 48	12	48	51.8	26	50	68	98	45	12	102	5 600	140	280		± 0.4		16.5	2.38

