



Stationary variable pitch pulleys for V-belts are mainly used in the fan industry. These pulleys allow adjustment to optimum working speed of fans by a simple operation on one pulley only.

Adjustment

Modifications of the pulley diameter must be done when stationary by moving the adjustable flange. Each complete rotation of one of the two disks results in a variation of the pulley diameter. When the required diameter is obtained, tighten the clamp screw on one of the two plates.

To get the same diameter in the two grooves of pulleys range D8000, screw the two mobile flanges on the central flange. Then unscrew the two mobile flanges by the same number of rounds to get the required diameter.

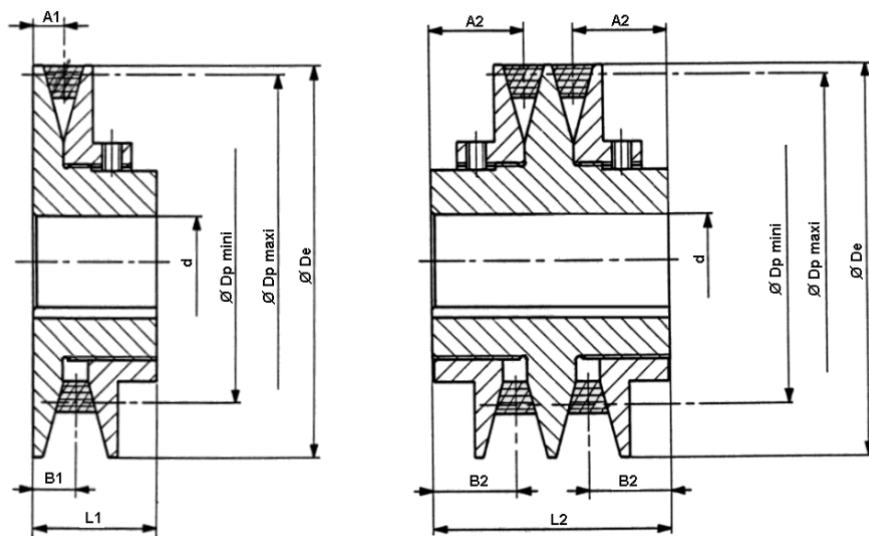

Features of pulleys

Reference		Weight (kg)		Ød		ØDe	L1	A1	B1	L2	A2	B2
1 groove	2 grooves	1 groove	2 grooves	mini	maxi							
8325	D 8325	0.64	1.36	13	28	83	45	8.5	14	85	36.5	31
8350	D 8350	0.91	1.82	13	28	96	45	10	15	85	35	30.5
8400	D 8400	1.27	2.27	13	28	106	45	10	15	85	35	30.5
8450	D 8450	1.36	2.72	13	28	121	45	10	15	85	35	30.5
8550	D 8550	1.82	3.63	13	42	136	45	10	15	85	35	30.5
8600	D 8600	2.27	4.53	13	42	153	45	10	15	85	35	30.5
8670	D 8670	2.72	5.44	13	42	171	45	10	15	85	35	30.5
8740	D 8740	3.18	6.35	13	42	188	45	10	15	85	35	30.5

Possible original Ø according to belt section used

Reference		Z		SPZ		A		SPA		B		SPB	
1 groove	2 grooves	Ø mini	Ø maxi	Ø mini	Ø maxi	Ø mini	Ø maxi	Ø mini	Ø maxi	Ø mini	Ø maxi	Ø mini	Ø maxi
8325	D 8325	58	78	63	79	60	76						
8350	D 8350	60	81	65	82	62	89	70	91	66	87	74	89
8400	D 8400	70	91	75	92	72	99	80	101	76	97	84	99
8450	D 8450	86	106	91	107	88	114	95	116	91	113	99	115
8550	D 8550	101	122	105	123	102	129	110	131	106	127	114	129
8600	D 8600	117	138	122	139	119	146	127	148	123	144	131	146
8670	D 8670	135	156	140	157	137	164	145	166	141	162	149	164
8740	D 8740	153	174	158	175	155	181	162	182	158	178	166	180

